



1. Salpa-ancore

Salpa-ancore V1/V2/V3

V1/V2/V3 comandi ed accessori

4 Magnetotermici



PART NO.	DESCRIPTION	FIT WINDLASS
68000348	Circuit Breaker 50A	V2 24V
68000349	Circuit Breaker 90A	V1/2 12V - V3 24V
68000350	Circuit Breaker 110A	V3 12V - V4/V5 24V
68000351	Circuit Breaker 150A	V4/V5 12V - V6 24V - V8 2.5kW
68000894	Circuit Breaker 200A	V8 3.5kW

5 Teleruttori



PART NO.	DESCRIPTION	V1	V2/V3
Sealed Contactors			
68000937	Compact Dual 12V	•	•
68000938	Compact Dual 24V		•
68000318	Dual 12V	•	•
68000319	Dual 24V		•
Contactors in Boxes			
68000129	Dual 12V	•	•
68000130	Dual 24V		•

6 Pulsanti ed accessori

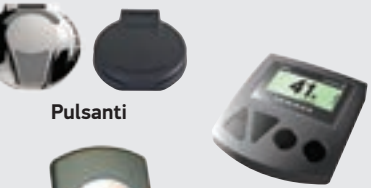

Pulsanti

Contacatena



Radiocomandi

informazioni a pagina 34-38

7 Accessori optional



Braccio spingicatena:
66810030



Kit recupero manuale

Solo barbotin: 66840054
Barbotin+campana: 66840056



Passaparatia
3 gland: 68000866



Maniglia
29140017

V1-V2-V3 - Dimensioni

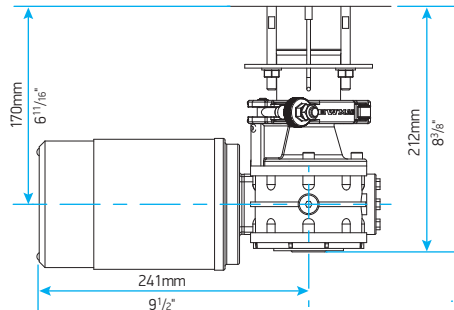
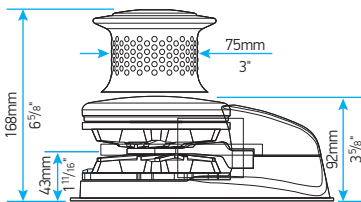

V1 Gruppo motore/riduttore
(con sistema FastFit)

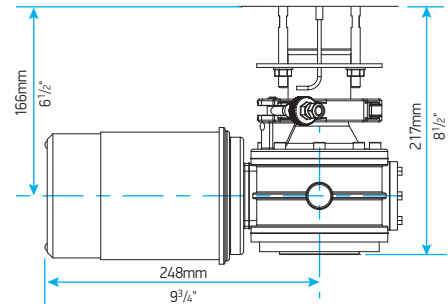

V2/3 Gruppo motore/riduttore
(con sistema FastFit)

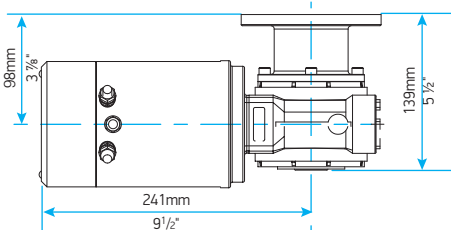
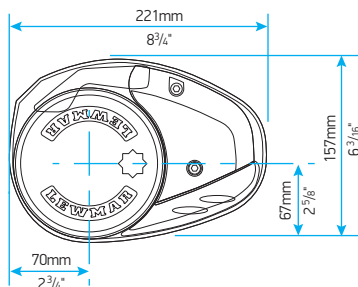

V1 Gruppo motore/riduttore
(senza sistema FastFit)

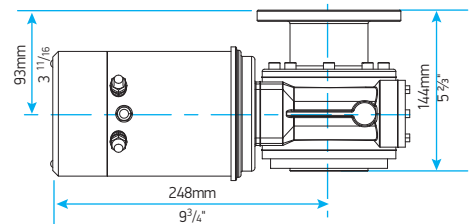

V2/3 Gruppo motore/riduttore
(senza sistema FastFit)